

BEARING UNITS

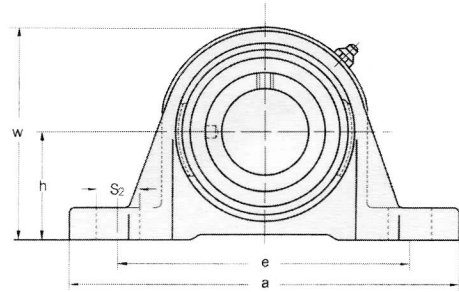

PILLOW BLOCKS SAPE 200 Series

Light Duty
Eccentric Collar Locking
Solid Base

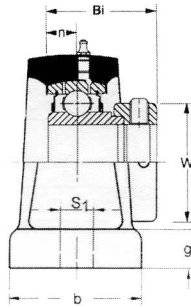

Unit No.	Shaft Dia.		Dimensions inch / mm										Bolt Size	Bearing No.	Housing No.	Weight Lbs kg
	In.	mm	h	a	e	b	S1	S2	g	w	Bi	n				
SAPE 201-8 202-10	1/2 5/8		1-3/16 30.16	4-7/8 123.8	3-3/4 95	1-7/32 30.9	7/16 11	19/32 15	9/16 14	2-1/4 57.1	1.126 28.6	0.236 6	3/8 M10	SA 201-8 202-10	PE203	0.99 0.45
SAPE 204 204-12	3/4	20	1-5/16 33.3	5 127	3-3/4 95	1-1/2 38	1/2 13	5/8 16	19/32 15	2-9/16 65	1.220 31	0.276 7	3/8 M10	SA 204 204-12	PE204	1.21 0.55
SAPE 205 205-14 205-15 205-16	7/8 15/16 1	25	1-7/16 36.6	5-1/2 140	4-1/8 105	1-1/2 38	1/2 13	5/8 16	5/8 16	2-3/4 70	1.220 31	0.295 7.5	3/8 M10	SA 205 205-14 205-15 205-16	PE205	1.76 0.8
SAPE 206 206-17 206-18 206-19 206-20	1-1/16 1-1/8 1-3/16 1-1/4S	30	1-11/16 42.9	6-1/2 165	4-49/64 121	1-7/8 48	21/32 17	13/16 21	23/32 18	3-9/32 83	1.406 35.7	0.315 8	1/2 M14	SA 206 206-17 206-18 206-19 206-20	PE206	2.64 1.2
SAPE 207 207-20 207-21 207-22 207-23	1-1/4 1-5/16 1-3/8 1-7/16	35	1-7/8 47.6	6-9/16 167	5 127	1-7/8 48	21/32 17	13/16 21	3/4 19	3-11/16 94	1.531 38.9	0.335 8.5	1/2 M14	SA 207 207-20 207-21 207-22 207-23	PE207	3.30 1.5
SAPE 208 208-24 208-25	1-1/2 1-9/16	40	1-15/16 49.2	7-1/4 184	5-25/64 137	2-1/8 54	21/32 17	31/32 25	3/4 19	3-15/16 100	1.720 43.7	0.354 9	1/2 M14	SA 208 208-24 208-25	PE208	4.40 2
SAPE 209 209-26 209-27 209-28	1-5/8 1-11/16 1-3/4	45	2-1/8 54	7-15/32 190	5-3/4 146	2-1/8 54	21/32 17	31/32 25	25/32 20	4-1/4 108	1.720 43.7	0.374 9.5	1/2 M14	SA 209 209-26 209-27 209-28	PE209	4.84 2.2
SAPE 210 210-30 210-31 210-32	1-7/8 1-15/16 2S	50	2-1/4 57.2	8-1/8 206	6-1/4 159	2-3/8 60	25/32 20	31/32 25	7/8 22	4-1/2 114	1.720 43.7	0.394 10	5/8 M16	SA 210 210-30 210-31 210-32	PE210	5.28 2.4