

BEARING UNITS



ADJUSTABLE FLANGE UNITS

UCFA 200 Series

Normal Duty

Set Screw Locking

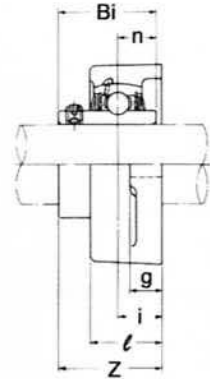
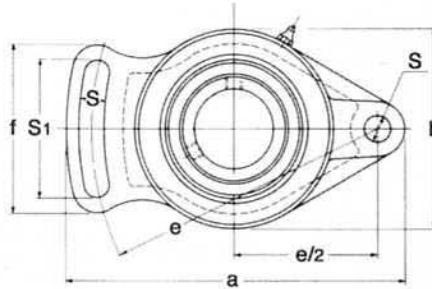

BEARING
UNITS

Unit No.	Shaft Dia.		Dimensions											Bolt Size	Bearing No.	Housing No.	Weight Lbs kg	
	In.	mm	inch / mm															
			a	e	i	g	ℓ	S	S1	b	f	Z	Bi					n
UCFA 201-8 202-10	1/2 5/8		3-27/32 98	3-1/16 78	19/32 15	15/32 12	1 25.5	25/64 10	1-9/16 40	2-3/8 60	1-31/32 50	1-5/16 33.3	1.2205 31	0.500 12.7	5/16 M8	UC 201-8 202-10	FA204	1.5 0.7
UCFA 204 204-12	3/4	20	3-27/32 98	3-1/16 78	19/32 15	15/32 12	1 25.5	25/64 10	1-9/16 40	2-3/8 60	1-31/32 50	1-5/16 33.3	1.2205 31	0.500 12.7	5/16 M8	UC 204 204-12	FA204	1.3 0.6
UCFA 205 205-14 205-15 205-16	7/8 15/16 1	25	4-7/8 124	3-25/32 96	19/32 15	9/16 14	1-1/32 26.5	33/64 13	1-15/16 49	2-3/4 70	2-17/32 64	1-23/64 34.7	1.3386 34	0.563 14.3	3/8 M10	UC 205 205-14 205-15 205-16	FA205	1.8 0.8
UCFA 206 206-17 206-18 206-19 206-20	1-1/16 1-1/8 1-3/16 1-1/4S	30	5-9/16 141	4-17/32 115	45/64 18	9/16 14	1-7/32 31	33/64 13	2-3/32 53	3-5/32 80	2-11/16 68	1-37/64 40.2	1.5000 38.1	0.626 15.9	3/8 M10	UC 206 206-17 206-18 206-19 206-20	FA206	2.6 1.2
UCFA 207 207-20 207-21 207-22 207-23	1-1/4 1-5/16 1-3/8 1-7/16	35	6-3/32 155	5-1/32 128	25/32 20	5/8 16	1-11/32 34	19/32 15	2-3/8 60	3-17/32 90	2-15/16 75	1-25/32 45.4	1.6890 42.9	0.689 17.5	7/16 M12	UC 207 207-20 207-21 207-22 207-23	FA207	3.3 1.5
UCFA 208 208-24 208-25	1-1/2 1-9/16	40	6-23/32 171	5-19/32 142	55/64 22	5/8 16	1-13/32 36	19/32 15	2-23/32 69	3-15/16 100	3-5/16 84	2-1/16 52.2	1.9370 49.2	0.748 19	1/2 M14	UC 208 208-24 208-25	FA208	4.0 1.8
UCFA 209 209-26 209-27 209-28	1-5/8 1-11/16 1-3/4	45	7-1/16 179	5-3/4 146	55/64 22	23/32 18	1-1/2 38	43/64 17	2-27/32 72	4-11/32 110	3-15/32 88	2-1/16 52.2	1.9370 49.2	0.748 19	1/2 M14	UC 209 209-26 209-27 209-28	FA209	4.9 2.2
UCFA 210 210-30 210-31 210-32	1-7/8 1-15/16 2S	50	7-7/16 189	6-3/32 155	55/64 22	23/32 18	1-9/16 40	43/64 17	2-15/16 75	4-17/32 115	3-5/8 92	2-5/32 54.6	2.0315 51.6	0.748 19	1/2 M14	UC 210 210-30 210-31 210-32	FA210	5.7 2.6