

WIDE INNER RING BEARINGS

CSA 200 Series
Light Duty
Eccentric Collar Locking

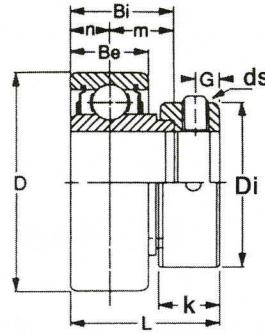

Cylindrical O. D.

Unit No.	Shaft Dia.		Dimensions inch / mm										Basic load Ratings lbf / N		Weight	
	In.	mm	D	L	Bi	Be	n	m	Di	K	G	ds	dynamic	static	kg	Lbs
													C	Co		
CSA 201		12													0.12	0.26
201-8	1/2														0.12	0.26
202		15	1-9/16 40	1-1/8 28.6	3/4 19	15/32 12	0.236 6	57/64 22.6	1-3/16 29	17/32 13.5	0.189 4.8	M6x1.0 1/4-28UNF	2160 9600	990 4400	0.11	0.24
202-10	5/8														0.11	0.24
203		17													0.10	0.22
CSA 204		20													0.17	0.37
204-12	3/4		1-27/32 47	1-1/4 31	27/32 21.5	9/16 14	9/32 7	15/16 24	1-19/64 33.0	17/32 13.5	0.189 4.8	M6x1.0 1/4-28UNF	2900 12890	1460 6490	0.16	0.35
CSA 205		25													0.20	0.44
205-14	7/8		2-1/16 52	1-1/4 31	27/32 21.5	19/32 15	0.295 7.5	59/64 23.5	1-1/2 38.0	17/32 13.5	0.189 4.8	M6x1.0 1/4-28UNF	3150 14000	1700 7560	0.21	0.46
205-15	15/16														0.21	0.46
205-16	1														0.19	0.42
CSA 206		30													0.31	0.68
206-17	1-1/16		2-7/16 62	1-13/32 35.7	15/16 23.8	5/8 16	5/16 8	1-3/32 27.7	1-3/4 44.5	5/8 15.9	0.236 6.0	M6x1.0 1/4-28UNF	4390 19510	2510 11160	0.33	0.73
206-18	1-1/8														0.33	0.73
206-19	1-3/16														0.30	0.66
206-20	1-1/4S														0.28	0.62
CSA 207		35													0.49	1.08
207-20	1-1/4		2-27/32 72	1-17/32 38.9	1 25.4	21/32 17	0.335 8.5	1-13/64 30.4	2-3/16 55.5	11/16 17.5	0.268 6.8	M8x1.0 5/16-24UNF	5770 25650	3450 15340	0.50	1.10
207-21	1-5/16														0.47	1.03
207-22	1-3/8														0.45	0.99
207-23	1-7/16															
CSA 208		40													0.66	1.45
208-24	1-1/2		3-5/32 80	1-23/32 43.7	1-3/16 30.2	23/32 18	11/32 9	1-23/64 34.7	2-3/8 60	23/32 18.3	0.268 6.8	M8x1.0 5/16-24UNF	6500 28890	3850 17110	0.64	1.41
208-25	1-9/16														0.61	1.34
CSA 209		45													0.65	1.43
209-26	1-5/8		3-11/32 85	1-23/32 43.7	1-3/16 30.2	3/4 19	3/8 9.5	1-11/32 34.2	2-1/2 63.5	23/32 18.3	0.268 6.8	M8x1.0 5/16-24UNF	7350 32670	4100 18220	0.76	1.67
209-27	1-11/16														0.73	1.61
209-28	1-3/4														0.70	1.54
CSA 210		50													0.70	1.54
210-30	1-7/8		3-35/64 90	1-23/32 43.7	1-3/16 30.2	25/32 20	13/32 10	1-5/16 33.7	2-3/4 69.8	23/32 18.3	0.268 6.8	M10x1.25 3/8-24UNF	7900 35120	4690 20850	0.83	1.83
210-31	1-15/16														0.79	1.74
210-32	2S														0.74	1.63
CSA 211		55													0.77	1.69
211-32	2		3-15/16 100	1-29/32 48.4	1-9/32 32.5	15/16 24	15/32 12	1-7/16 36.4	3 76.2	13/16 20.6	5/16 8	M10x1.25 3/8-24UNF	9750 43340	5850 26000	0.96	2.11
211-34	2-1/8														0.87	1.91
211-35	2-3/16														0.81	1.78

