

BEARING UNITS

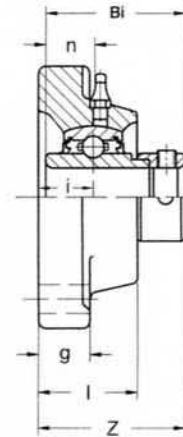

FOUR BOLT FLANGE UNITS HCFS 200 Series Normal Duty Eccentric Collar Locking

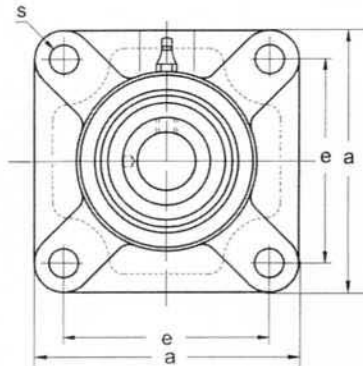

BEARING
UNITS

Unit No.	Shaft Dia.		Dimensions inch / mm								Bolt Size	Bearing No.	Housing No.	Weight Lbs kg												
	In.	mm	a	e	i	g	l	s	z	Bi					n											
HCFS 201-8	1/2	20	3-25/64 86	2-1/2 63.5	3/4 19	19/32 15	1-11/64 29.5	15/32 12	1-51/64 45.5	1.713 43.5	0.669 17	HC 201-8	FS204	1.76 0.8												
202-10	5/8														202-10											
204	204																									
204-12	3/4														204-12											
HCFS 205		25	3-43/64 93	2-3/4 70	3/4 19	19/32 15	1-3/16 30	15/32 12	1-13/16 45.8	1.744 44.3	0.685 17.4	HC 205	FS205	1.98 0.9												
205-14	7/8	205-14																								
205-15	15/16	205-15																								
205-16	1	205-16																								
HCFS 206		30	4-11/64 106	3-1/4 82.5	25/32 20	5/8 16	1-9/32 32.5	15/32 12	1-31/32 50	1.902 48.3	0.717 18.2	HC 206	FS206	2.86 1.3												
206-17	1-1/16	206-17																								
206-18	1-1/8	206-18																								
206-19	1-3/16	206-19																								
206-20	1-1/4S	206-20																								
HCFS 207		35	4-9/16 116	3-5/8 92	13/16 21	21/32 17	1-3/8 35	9/16 14	2-7/64 53.3	2.012 51.1	0.740 18.8	HC 207	FS207	3.96 1.8												
207-20	1-1/4	207-20																								
207-21	1-5/16	207-21																								
207-22	1-3/8	207-22																								
207-23	1-7/16	207-23																								
HCFS 208		40	5-5/64 129	4 101.5	15/16 24	21/32 17	1-17/32 39	5/8 16	2-21/64 58.9	2.217 56.3	0.843 21.4	HC 208	FS208	4.62 2.1												
208-24	1-1/2	208-24																								
208-25	1-9/16	208-25																								
HCFS 209		45													5-5/16 135	4-1/8 105	15/16 24	23/32 18	1-9/16 40	5/8 16	2-21/64 58.9	2.217 56.3	0.843 21.4	HC 209	FS209	5.50 2.5
209-26	1-5/8	209-26																								
209-27	1-11/16	209-27																								
209-28	1-3/4	209-28																								
HCFS 210		50	5-5/8 143	4-3/8 111	1-3/32 28	25/32 20	1-25/32 45	5/8 16	2-19/32 66.1	2.469 62.7	0.969 24.6	HC 210	FS210	6.38 2.9												
210-30	1-7/8	210-30																								
210-31	1-15/16	210-31																								
210-32	25	210-32																								
HCFS 211		55	6-3/8 162	5-1/8 130	1-1/4 31	13/16 21	1-59/64 49	3/4 19	2-15/16 74.6	2.811 71.4	1.091 27.7	HC 211	FS211	9.24 4.2												
211-32	2	211-32																								
211-34	2-1/8	211-34																								
211-35	2-3/16	211-35																								
HCFS 212		60	6-7/8 175	5-5/8 143	1-11/32 34	7/8 22	2-7/64 53.5	3/4 19	3-11/64 80.7	3.059 77.7	1.217 30.9	HC 212	FS212	11.44 5.2												
212-36	2-1/4	212-36																								
212-38	2-3/8	212-38																								
212-39	2-7/16	212-39																								
HCFS 213		65	7-1/4 184	5-55/64 149	1-1/2 38	7/8 22	2-9/32 58	3/4 19	3-35/64 89.6	3.374 85.7	1.343 34.1	HC 213	FS213	13.42 6.1												
213-40	2-1/2	213-40																								
HCFS 214		70													7-13/32 188	5-31/32 152	1-1/2 38	29/32 23	2-3/8 60	3/4 19	3-35/64 89.6	3.374 85.7	1.343 34.1	HC 214	FS214	13.20 6
214-44	2-3/4	214-44																								
HCFS 215		75	7-7/8 200	6-1/4 159	1-5/8 41	15/16 24	2-7/16 62	3/4 19	3-25/32 95.8	3.626 92.1	1.469 37.3	HC 215	FS215	16.50 7.5												
215-47	2-15/16	215-47																								
215-48	3	215-48																								